

**KVR667D2S5/4G**  
**4GB 512M x 64-Bit DDR2-667**  
**CL5 200-Pin SODIMM**

**DESCRIPTION:**

This document describes ValueRAM's 512M x 64-bit 4GB (4096MB) CL5 DDR2-667 SDRAM (Synchronous **DRAM**) memory module. The components on this module include sixteen stacked 256M x 8-bit DDR2-667 SDRAM. This 200-pin SODIMM uses gold contact fingers and requires +1.8V. The electrical and mechanical specifications are as follows:

**FEATURES:**

✓ Clock Cycle Time (tCK) CL=5	3ns
✓ Row Cycle Time (tRC)	60ns (min.)
✓ Refresh to Active/Refresh Command Time (tRFC)	195ns
✓ Row Active Time (tRAS)	45ns (min.)/70,000ns (max.)
✓ Single Power Supply of	+1.8V (+/- .1V)
✓ Power	1.368 W (operating)
✓ UL Rating	94 V - 0

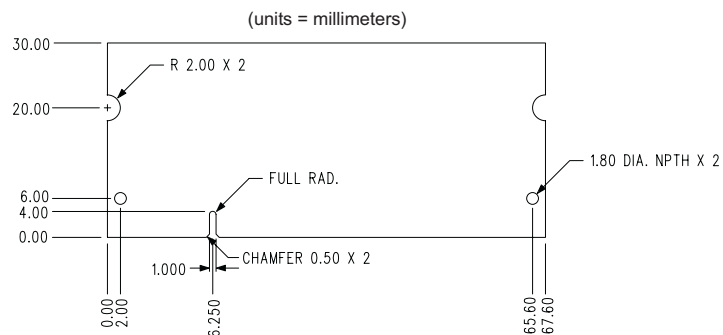
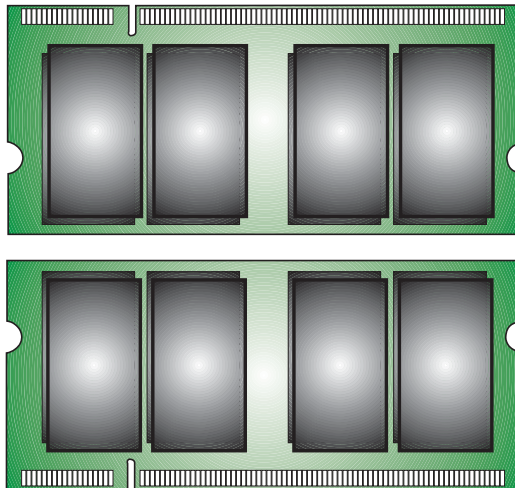

**Figure 1: KVR667D2S5/4G 200-Pin SODIMM**